

- A. Recovery tank cover
- B. Solution tank twist latch
- C. Control panel (see OPERATION below)
- D. Vacuum hose attachment
- E. Handle extension release/lock pin
- F. Recovery tank drain
- G. Solution hose quick-connect
- H. Cord wrap

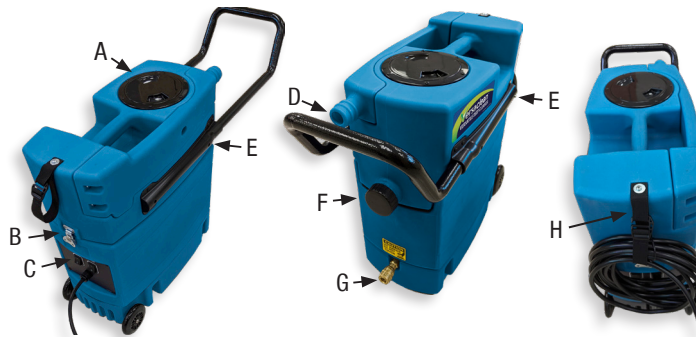

**WARNING**  
**FIRE AND ELECTRIC SHOCK HAZARD**  
 Unit must be electrically grounded. Plug provided power cord only into outlet with GFCI device. Do not use adapter. Never cut off third prong. Do not use with extension cord. **Keep motor and wiring dry.** Do not expose to rain or snow. Do not use to pick up flammable or combustible liquids or burning, hazardous or toxic materials, or use in areas where such substances may be present. **Read and understand manual before use.**

### BEFORE CLEANING

- 1 Press release button to extend the handle for transport.



- 2 Twist the end latch, slide the recovery tank forward and lift up. Set tank aside.

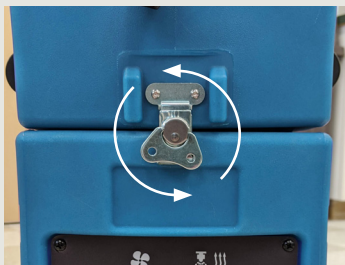

**DO NOT add more than 2 gallons.**

- 3 For plain water cleaning, add water to solution tank.



- 4 To use with a cleaning solution, pre-mix UN-DUZ-IT™ Deep Steam Cleaner with water in a separate container. Pour mixed solution into the solution tank.

- 5 Replace recovery tank and twist the latch to lock it in place.

- 6 Connect vacuum and solution hoses. (Slide brass ring back to connect solution hose.)



- 7 Make sure both switches are OFF. Plug into available 15-amp grounded outlet. **DO NOT USE** if ground plug is broken.

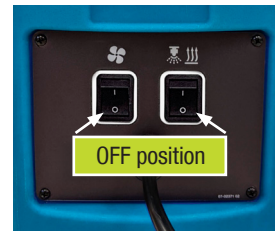

### OPERATION

1. Turn on the Blower and Pressure Pump/Heater.

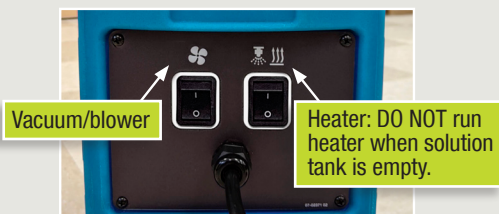

2. Begin cleaning.  
 Before starting, wait a minute or two for the heated solution to reach the hand tool.

### CLEANING

1. **Apply prespray (optional).**  
 Apply solution directly to soiled surface as directed by the chemical manufacturer.
2. **Rinse/extract with VDC.**  
 Rinse and extract either with plain water or with UN-DUZ-IT Deep Steam Cleaner solution.
3. **Pull tool across cleaned surface multiple times to extract as much water as possible.**
4. **Dry completely.**  
 Accelerate drying with warm air and carpet dryer.

#### Cleaning Tips:

- » Vacuum before applying prespray or extraction cleaning.
- » Test surfaces first for colorfastness.
- » Clean small sections at a time. If you're using prespray, DO NOT let it dry on surfaces.
- » Take care not to over-wet.

## Empty/refill tanks

When the cleaning solution is used up: 1) empty the recovery tank and 2) refill the solution tank.

### 1. Empty recovery tank.

Switch off blower and heater. With the vacuum hose still attached to the unit, lift the vacuum hose above the height of the vacuum intake to drain any water in the hose into the recovery tank.

Remove vacuum hose from recovery tank. Turn the tank release twist latch and slide the recovery tank forward and up.

Keep the vacuum inlet tipped upward to avoid drips from the vacuum intake. While holding the tank upright, unscrew tank cap.

Carefully pour into a suitable drain, such as a toilet or utility sink.

**2. Refill solution tank** (as shown on previous page) whenever you empty the recovery tank or when you notice that solution is no longer flowing from the spray nozzle.

**3. Resume cleaning.**



## MAINTENANCE

**Before servicing, turn off all controls, then unplug machine.**

### DAILY OR AFTER EACH USE

» **Press accessory tool control lever to release water pressure, then disconnect vacuum hose.**

» **Rinse solution tank.**

» **Clean strainer cup and float ring.** Remove deck plate cover, lift out parts shown and rinse clean.

» **Rinse recovery tank.**

» **Reassemble unit and turn on blower motor ONLY. (DO NOT turn on heater.) Allow blower to run for 2 minutes.** This helps to remove any remaining moisture from the blower.

» **Coil power cord and secure with strap.**



### AS NEEDED

» **Wipe exterior surfaces with a damp cloth.** To restore exterior shine, use an automotive vinyl cleaner/protectant product.

**NOTICE: Follow all instructions to avoid damaging machine and voiding warranty.**

- Use only manufacturer's recommended cleaning solutions and accessory tools.
- Add defoamer to recovery tank in case of excessive foaming.
- Keep cord away from heated surfaces.
- To unplug, grasp the plug, not the cord. Do not pull cord to unplug.
- Protect from freezing to avoid damage to internal components.
- Do not immerse end of vacuum hose in liquid.
- Do not use as a dry vacuum.
- To prevent growth of mold and mildew inside tanks, always drain recovery tank after use.
- Do not modify machine from its original design.

**Read and understand manual before operating.**

## TECHNICAL SUPPORT AND SERVICE

**Live chat:** [Info.legendbrands.com](https://www.legendbrands.com)

**Email:** [service@cleanerlivingproducts.com](mailto:service@cleanerlivingproducts.com)

15180 Josh Wilson Road

Burlington, WA 98233

800-932-3030

**CleanerLivingProducts.com**

For detailed instructions and product information, download the manual under "Documents" at [VDC.cleanerlivingproducts.com](https://vdc.cleanerlivingproducts.com)